

INSTRUCTION MANUAL

Thank you for purchasing the SEIKO CHROMATIC TUNER STX5. Carefully read this instruction manual before using your STX5 as proper use is important to ensure the life of the product.

Store this instruction manual in a place that is readily accessible and refer to it regularly.

FOR SAFE OPERATION

The following warnings and cautions are important in ensuring safe and proper use of the product, preventing injury to yourself and others, and preventing damage to your belongings.

— Please adhere to the following warnings. —



WARNING

Disregard of these warnings may result in injury or death.



- Do not disassemble, attempt to repair, or tamper with the tuner or battery.



- Do not handle the tuner with wet hands.



- Do not use or store the tuner in places where it may become wet such as in bathrooms, near sinks, or outdoors.



- Do not expose the battery to fire.
- Use only the battery specified for the tuner.
- Do not insert pins or other foreign objects into the tuner.
- Do not place the tuner on unstable surfaces.
- Do not intentionally throw or drop the tuner.
- Do not use or store the tuner in places where it may be exposed to extremely high temperatures such as near heaters, on devices that generate heat, in direct sunlight, or in vehicles.
- Do not use or store the tuner in places where it may be exposed to extremely high levels of humidity.



- Do not let small children play with the tuner.
- Keep removed battery and the battery lid out of the reach of small children. In the event that a child swallows these parts, contact a physician immediately.



CAUTION

Disregard of these cautions may result in injury or physical damage.



- Do not exceed the stipulated range of movement of the clip.
- Do not apply excessive force to the buttons or body of the tuner.
- Do not let leaked battery fluid come in contact with your skin.
- Do not use or store the tuner in dusty places or places prone to vibration.
- Do not use thinner or alcohol to clean the tuner.



- Install the battery properly, checking that the (+) and (-) terminals are oriented correctly.
- Be careful not to pinch fingers in the clip.
- Remove the clip from your instrument when not using the tuner.
- Remove the battery when it is depleted or when not using the tuner for a long period of time.

Before using the tuner for the first time, remove the battery pull tab by gently pulling the tab in the direction of the arrow shown in the drawing. The battery included with the tuner is for functionality testing and its life may be shorter than expected.

NAMES OF PARTS

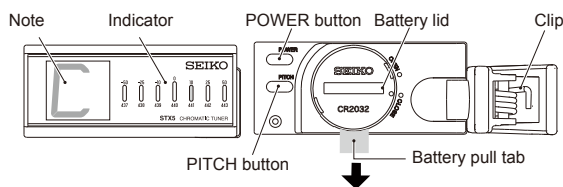

TUNING YOUR GUITAR/BASS

■ Attaching the Tuner

Clip the tuner securely to your instrument and adjust the clip so that you can see the screen clearly. Make sure that adjustments made to the clip are within its stipulated range of movement (see drawing).

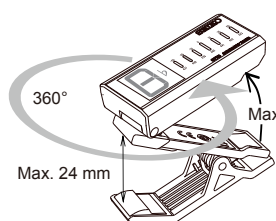

Range of movement of the clip

The STX5 allows you to tune your instrument by detecting vibrations generated by your instrument. If you experience difficulty tuning, clip the tuner to a different part of your instrument or adjust the orientation of the clip.

* Do not exceed the stipulated range of movement of the clip.

* Remove the clip from your instrument when not using the tuner. Leaving the tuner clipped to your instrument for a long time may result in marking or discoloration of your instrument.

■ Tuning your Instrument

Press the POWER button to turn on your tuner. When turned on, the last A4 reference pitch that was set will flash on the indicator. Press the PITCH button to set the reference pitch according to the reference pitch meter. The tuner automatically indicates the note closest to the input note and the discrepancy between the input note and the note shown on display. The middle (green) lamp of the indicator will light up when the played note is in tune.

* Ambient sound or hum noise from electronic appliances may cause the tuner to behave as if in use. This is not a malfunction.

* After a short period of tuning or button inactivity while the tuner is turned on, the LCD screen will be dimmed incrementally. The tuner will automatically turn off after about ten minutes of inactivity. This function is provided to extend the life of the battery.

* In some cases, instruments that produce harmonic overtones or tones that deteriorate quickly may not tune accurately.

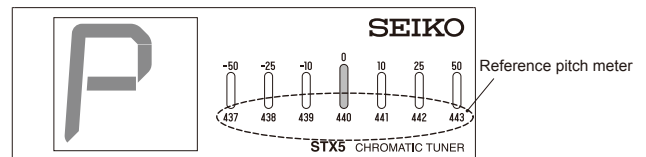

Display when setting reference pitch (440Hz shown)

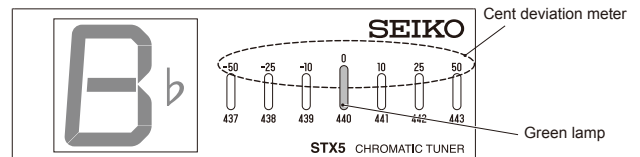

Display when in tune (B \flat shown)

BATTERY REPLACEMENT

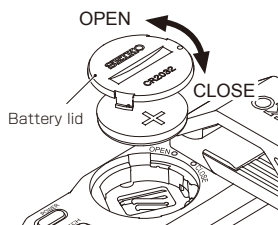

Dimming of the tuning lamps or the LCD screen occurs when the battery is depleted. In these cases, replace the battery immediately.

Press the POWER button to turn off the tuner. Turn the tuner over and rotate the clip until the battery lid is completely exposed. Use a coin, etc. to rotate the battery lid counterclockwise until the tab on the battery lid aligns with the OPEN position and remove the depleted battery. Install a new battery (model number:

CR2032) with the (+) side facing up. Replace the battery lid and rotate it clockwise until the tab on the battery lid aligns with the CLOSE position. After replacing the battery, confirm that the tuner functions normally. Reference pitch settings are reset to factory settings (440 Hz) when the battery is replaced.

* Be sure that the (+) and (-) terminals of the battery are oriented correctly.

* Follow all local ordinances and regulations when disposing of the depleted battery.

Keep removed battery and the battery lid out of the reach of small children. In the event that a child swallows these parts, contact a physician immediately.

SPECIFICATIONS

- Tuning mode : Auto chromatic
- Tuning range (accuracy) : A0~C8 (± 1 cent)
- Pitch shift : A4= 437 ~ 443 Hz (1 Hz steps)
- Auto power-off : 10 min.
- Input method : Built-in vibration sensor
- Power supply : Lithium battery (CR2032 \times 1)
- Battery life : Approx. 15 hours (at continuous A4 input)
- Overall dimensions and weight : 62 (W) \times 26 (H) \times 34 (D) mm (excluding protruding parts); approx. 35g (including battery)
- Opening range of the clip : 24 mm
- Accessories : Instruction manual and one (1) Lithium battery CR2032 (for functionality testing)

* The design and specifications are subject to change without prior notice for product improvement.